

1	2	3	4	5	6	7	8	9	10	11	12	13	14	15	16	17	18	19	20	21	22	23	24	25	26	27	28	29	30	31	32	33	34	35	36	37	38	39	40	41	42	43	44	45	46	47	48	49	50	51	52	53	54	55	56	57	58	59	60	61	62	63	64	65	66	67	68	69	70	71	72	73	74	75	76	77	78	79	80	81	82	83	84	85	86	87	88	89	90	91	92	93	94	95	96	97	98	99	100
---	---	---	---	---	---	---	---	---	----	----	----	----	----	----	----	----	----	----	----	----	----	----	----	----	----	----	----	----	----	----	----	----	----	----	----	----	----	----	----	----	----	----	----	----	----	----	----	----	----	----	----	----	----	----	----	----	----	----	----	----	----	----	----	----	----	----	----	----	----	----	----	----	----	----	----	----	----	----	----	----	----	----	----	----	----	----	----	----	----	----	----	----	----	----	----	----	----	----	-----

FOR NOTES SEE SHEET 1
COLD WEATHER OPTIONAL-C13

CATERPILLAR

390-1189
PAGE ONE OF 10

SEE SHEET 5

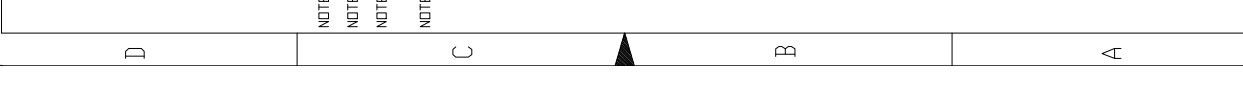
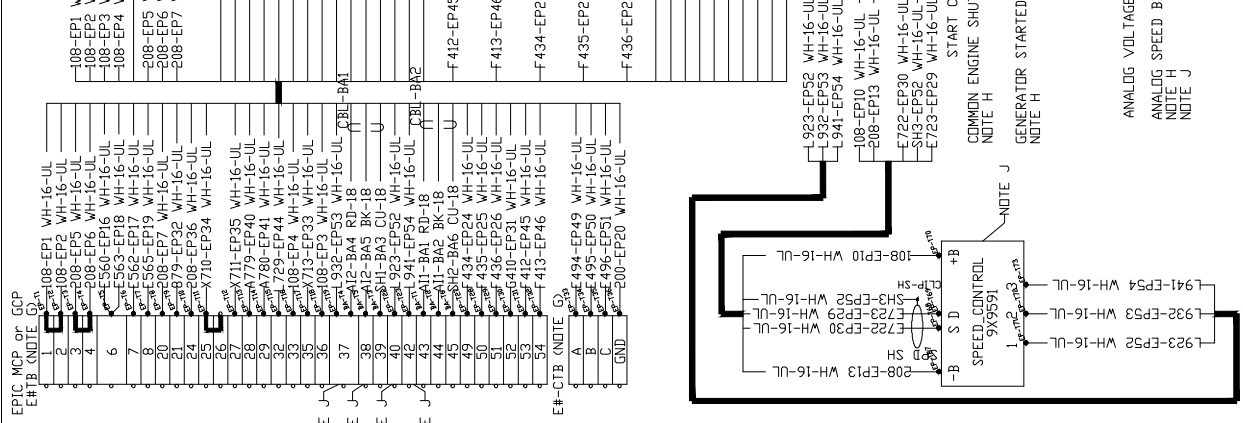
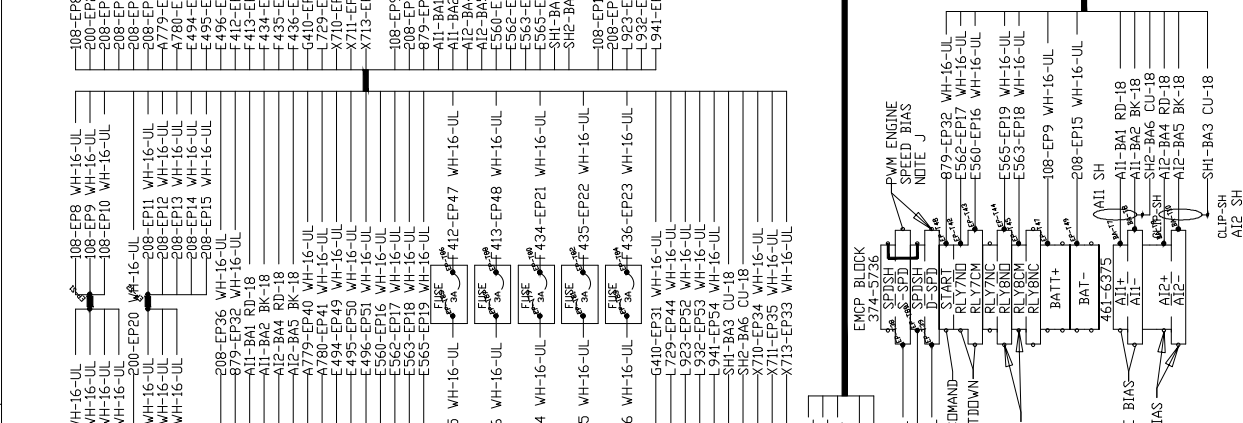
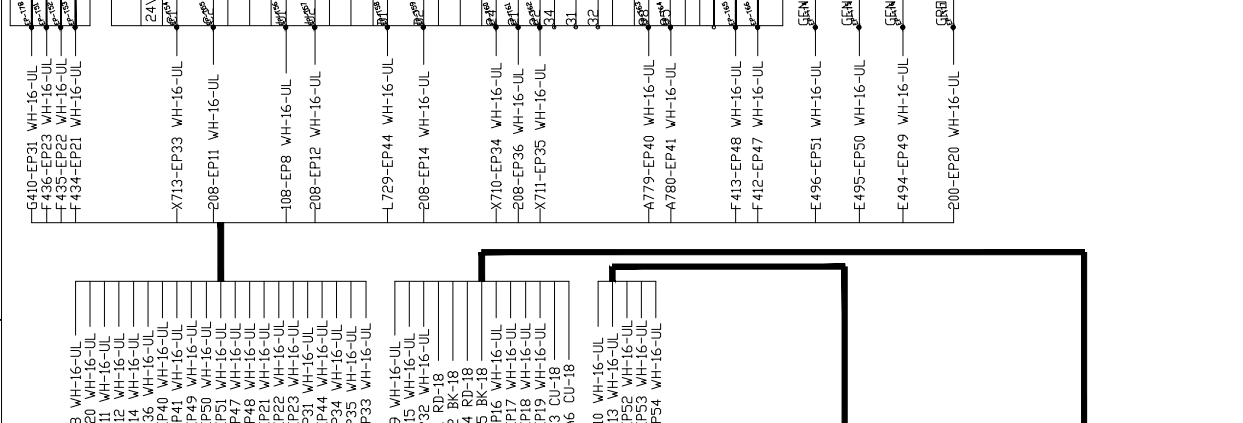
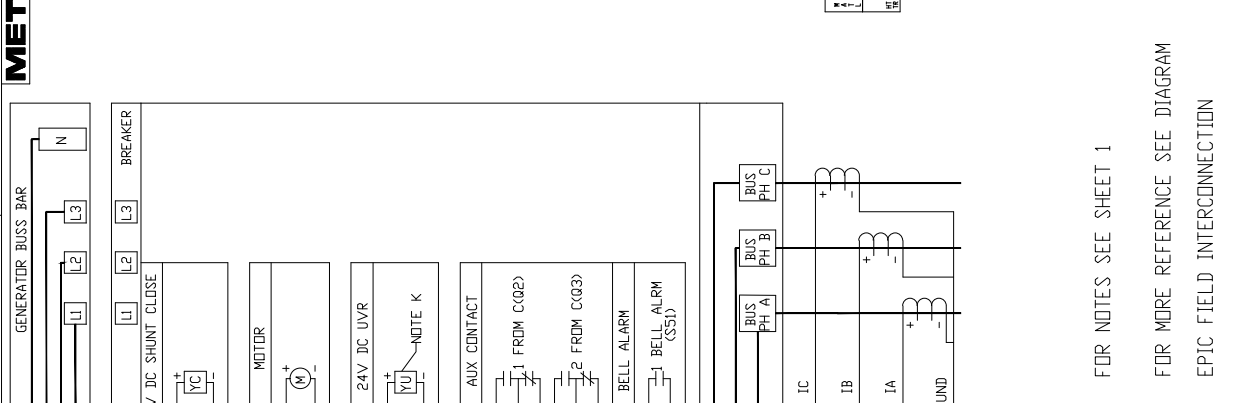

TELEMATICS

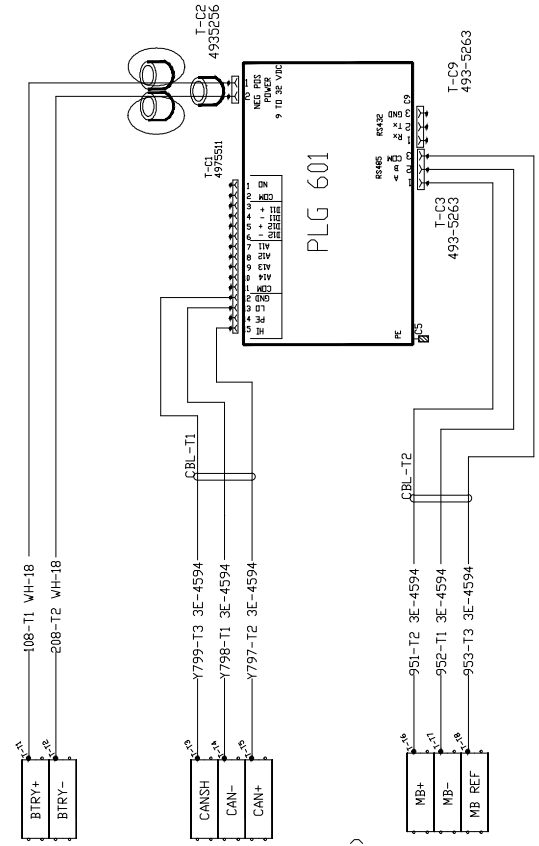

TELEMATICS

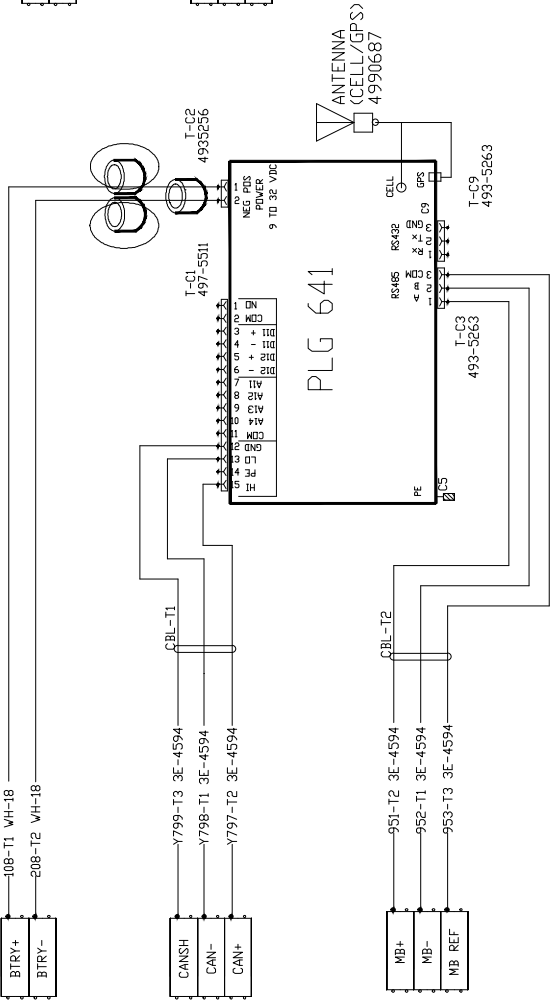

INT-PRDP	INT-PRDP	REVISION	PRIMARY
DRAWING	DRAWING	TYPE	SECONDARY
BRAND MARKINGS	BRAND MARKINGS	DATE	
CONFIDENTIALITY	CONFIDENTIALITY	SHEET	16 OF 17
INTERPRETATION	INTERPRETATION	PROJECTION	W 973
INTPR & TOL	INTPR & TOL		
Confidentiality: Confidential Yellow			

CATERPILLAR

FOR NOTES SEE SHEET 1

TELEMATICS PLG601 & PLG641

D

C

B

A

D

C

B

A

C27-C32

Enclosures



Image shown may not reflect actual configuration.

Sound Attenuated Enclosures for C27 and C32 Generator Sets

These sound attenuated, factory installed enclosures are designed for safety and aesthetic value. Rugged construction provides weather protection and the ability to withstand exposure to the elements.

Features

Robust/Highly Corrosion-Resistant Construction

- Environmentally friendly, polyester powder-baked paint in Caterpillar yellow
- Zinc plated or stainless steel fasteners
- 14-gauge steel construction
- Pitched roof for improved rain ingress protection
- Critical grade internally mounted muffler/exhaust system
- Vibration spring isolators
- 75 dBA at 7 m

Excellent Access

- Control panel mounted on left side or right side of package
- Large cable entry area for ease of installation
- Left-hand or right-hand bottom entry access to power cable bus or circuit breaker
- Double doors on both sides
- Lube oil and coolant drains piped to exterior of enclosure and terminated drain valves

Options

- Interior AC lighting system and AC receptacles (interior and exterior)
- AC distribution box
- Interior DC lighting system with automatic shutoff timer
- Cold-weather bundle, including motorized louvers (powered closed), backdraft dampers, and enclosure space heater
- Caterpillar Yellow (default), white, grey, or beige paint
- 1000, 2000, and 3600 gallon fuel tanks
- 120 mph wind loading

Security and Safety

- Lockable access doors with standard key use
- Cooling fan and battery charging alternator fully guarded
- Oil fill and battery can only be reached via lockable access
- External fuel connections
- Externally mounted emergency stop button
- Designed for spreader-bar lifting to ensure safety

Certifications

- UL Listed
- Seismic certification per applicable building codes: IBC 2000, IBC 2003, IBC 2006, IBC 2009, IBC 2012, CBC 2007
- IBC certifiable for 120 mph wind loading
- Tested and analyzed in accordance with: ASCE 7-98, ASCE 7-02, ASCE 7-05, ICC-ES AC-156

Enclosure Weights and Dimensions

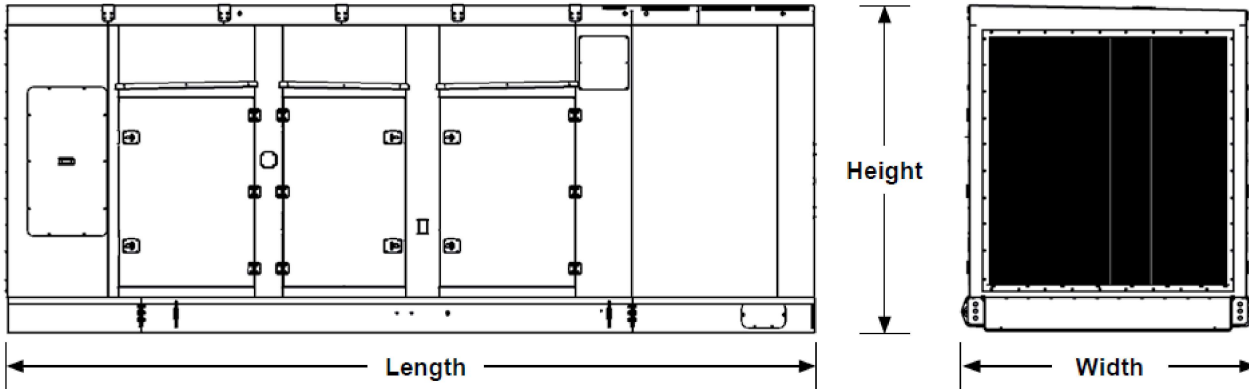

Note: For reference only – do not use for installation design. Please contact your dealer for exact weights and dimensions.

Enclosure Base Options	Weight		Length		Width		Height	
	kg	lbs	mm	in	mm	in	mm	in
With Lifting Base	3500	7716	7010	276	2554	101	2844	112
With 1000 gal integral tank base	5920	13,051	7645	301	2554	101	3213	127
With 2000 gal integral tank base	6050	13,338	7645	301	2554	101	3213	127
With 3600 gal tank with lifting base	7000	15,432	9750	384	2554	101	3759	148

*Weight does not include package generator set weight.

	Generator Set Wights**	
	kg	lbs
C27 Open Generator Set	6622	14,600
C32 Open Generator Set	6668	14,700

**Dry Weight

Note: For reference only - do not use for installation design. Please contact your dealer for exact weights and dimensions.

www.cat.com/electricpower
 ©2020 Caterpillar
 All rights reserved.

LET'S DO THE WORK.™

Materials and specifications are subject to change without notice.
 The International System of Units (SI) is used in this publication.

CAT, CATERPILLAR, LET'S DO THE WORK, their respective logos, "Caterpillar Corporate Yellow", the "Power Edge" and Cat "Modern Hex" trade dress as well as corporate and product identity used herein, are trademarks of Caterpillar and may not be used without permission.

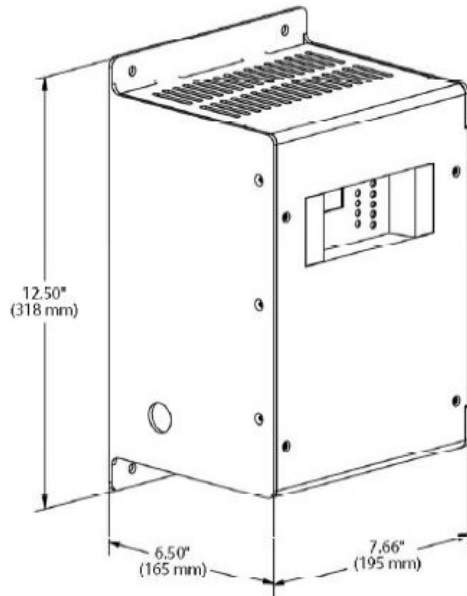

Image Shown may not Reflect Actual Package.

Features

- Electronically current limited at 105% of rated output
- Alarm system
- Digital display
- Lightning and voltage transient protection
- Protection of connected equipment against load dump protection
- Constant voltage, current limited, 4-rate automatic equalization
- IP 20 housing
- Temperature compensation
- On board temperature sensor with remote port
- Auto AC line compensation
- Output regulated by sensed battery voltage

UL 10 Amp Battery Charger

This battery charger offers accurate, automatic charging of lead-acid and nickel cadmium batteries. The output voltage automatically adjusts to changing input, load, battery and ambient conditions. This prevents battery over-charging and consequent loss of battery electrolyte.

Standard features include AC line compensation, precision voltage regulation, current limiting, automatic 2-rate charging, voltmeter and ammeter, temperature compensation and UL Listing.

The user interface is easy to understand with digital metering, NFPA 110 alarms and a battery fault alarm.

Standards

- C-UL listed to UL 1236
- NFPA 70, NFPA 110
- CSA 22.2 No 107 certified
- CE DOC to EN 60335
- IBC Seismic Certification

Specifications

Input supply	110 – 120 V 208 – 240 V
AC and DC fuses	2 input and 2 output)
Output voltage	24V
Output amps	10
Frequency	50 / 60 Hz
Operating temperature	-20°C (-4°F) to +60°C (140°F)
Housing constructed of rustproof anodized Aluminum	

Dimensions			
Width	Depth	Height	Weight
195 mm (7.66 in)	165 mm (6.5 in)	318 mm (12.5 in)	10.4 kg (23 lb)

NFPA 110 alarm package as follows:

- AC on Green led (indication)
- AC fail Red led and form C contact (2A)
- Float mode LED
- Fast charge LED
- Temp comp active LED
- Low battery volts Red led and Form C conta
- High Battery Volts Red led and Form C conta
- Charger fail Red led and Form C conta
- Battery fault Red led and Form C conta
- Battery disconnected
- Battery polarity reversed
- Mismatched charger battery voltage
- Open or high resistance charger to battery connection
- Open battery cell or excessive internal resistance

Feature Codes:

BTC1024 BTC1028 BTC1035 BTC1025 BTC1032

Information contained in this publication may be considered confidential. Discretion is recommended when distributing. Materials and specifications are subject to change without notice.

CAT, CATERPILLAR, LET'S DO THE WORK, their respective logos, "Caterpillar Yellow," the "Power Edge" and Cat "Modern Hex" trade dress as well as corporate and product identity used herein, are trademarks of Caterpillar and may not be used without permission.



Jacket Water Heater with Pump Diesel Gensets: C27, C32

Caterpillar offers a factory installed Jacket Water Heater for improved cold-starting capability.

The Jacket Water Heater with the pump is a complete coolant preheater with thermostat, pump and all required controls.

Forced circulation of the coolant delivers uniform heating throughout the entire engine, reduces wear from Cold spots and offers a significant reduction in electrical consumption.

The Jacket Water Heater operates automatically when provided contacts are supplied with a 24 Volt DC signal from the engine.

Features

- Factory Installed
- Complete with hoses, thermostat and pump
- Base frame mounting minimizes engine induced vibration
- Automatically disconnected when engine is running via the generator space heater relay
- Supplied with UL recognized components
- Thermostat is factory pre-set to 54°C (130°F)

Heater Design Description

The jacket water heater package is designed to efficiently pre-heat the engine by heating and circulating the engine's coolant.

This design results in the following benefits

- Increase life of heater hoses, engine seals, and heating elements.
- Improve heat transfer efficiency from elements to engine coolant.
- More uniform engine temperature distribution
- Application of a thermostat with a reduced thermal differential.
- Lower customer utility costs and increased heater reliability.
- Heater thermostat's setpoint is preset from the factory

Heater Operation / Wiring

A 32 L/pm (10 gpm) pump is located at the heater outlet to push the coolant through the heater. A fixed thermostat is located inside the heater tank near the outlet of the heater and responds to the temperature of the coolant entering the tank. The figure below shows the general heater design.

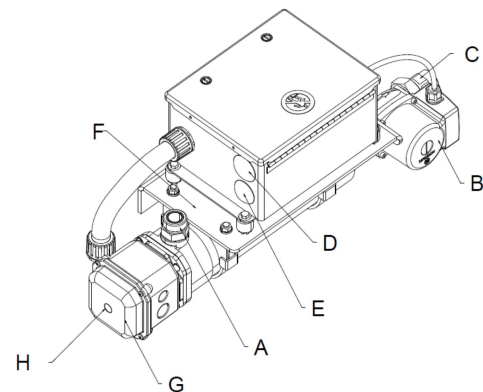

- | | |
|------------------------------|----------------------------|
| A. Discharge port | E. Control wiring entrance |
| B. pump / motor | F. Mounting Base |
| C. Suction (behind unit) | G. Element assembly |
| D. Power in writing entrance | H. Thermostat |

Specifications

	Voltage	
	240	220
Ratings	9 kW	9 kW
Frequency	60	50
Phase	Single	Single
Amps	37.5A	41A
Flow Rate	38 L/pm(10 GPM)	38 L/pm(10 GPM)
Pump Rating	240 VAC 97W	220VAC 90W
Fixed Thermostat	38°C - 54°C (100°F - 130°F)	
Length	694.8 mm (27.3")	
Width	213.7 mm (8.4")	
Height	290.6 mm (11.4")	
Weight	18.84 Kg (41.54 lbs)	

