

SPECIFICATIONS

Table 1. Generator Specifications

Model	DCA250SSI/DCA250SSIU
Type	Revolving field, self ventilated, open protected type synchronous generator
Armature Connection	Star with Neutral
Phase	3
Standby Output	220 kW (275 kVA)
Prime Output	200 kW (250 kVA)
Voltage — 1Ø	120, 127, 139, 240, 254 and 277V
Voltage — 3Ø	208, 220, 240, 416, 440 and 480V
Frequency	60 Hz
Speed	1800 rpm
Power Factor	0.8
Aux. AC Power	Single Phase, 60 Hz
Aux. Voltage/Output	120VAC/4.8 Kw (2.4 kW x 2)
Sound Level dB (A) Full Load at 23 ft. (7.0 Meters)	68
Dry Weight	8,203 lbs. (3,720 kg)/8,303 lbs. (3,766 kg)
Wet Weight	9,305 lbs. (4, 220 kg)/9,360 lbs. (4, 245 kg)/
Maximum Lifting Capacity	16,500 lbs. (7,484 kg)

Table 2. Engine Specifications

Model	ISUZU BH6UZ1X EPA Tier 3 Certified	
Type	4 cycle, water-cooled, direct injection, turbo-charged air-cooled	
No. of Cylinders	6 cylinders	
Bore x Stroke	4.72 in. x 5.71 in. (120 mm x 145 mm)	
Displacement	600 cu. in. (9,839 cc)	
Rated Output	308 HP at 1800 rpm	
Starting	Electric 24 VDC	
Coolant Capacity	14.3 gal. (54.0 liters)	
Lube Oil Capacity	10.8 gal. (41.0 liters)	
Fuel Type	#2 Diesel Fuel	
Fuel Tank Capacity	121 gal. (460 liters)/129 gal. (490 liters)	
Fuel Consumption	14.7 gal. (55.8 L)/hr at full load	10.9 gal. (41.2 L)/hr at 3/4 load
	7.5 gal. (28.5 L)/hr at 1/2 load	4.4 gal. (16.6 L)/hr at 1/4 load
Battery	12V-150 Ah x 2/4D CCA 925 X 2	

DIMENSIONS

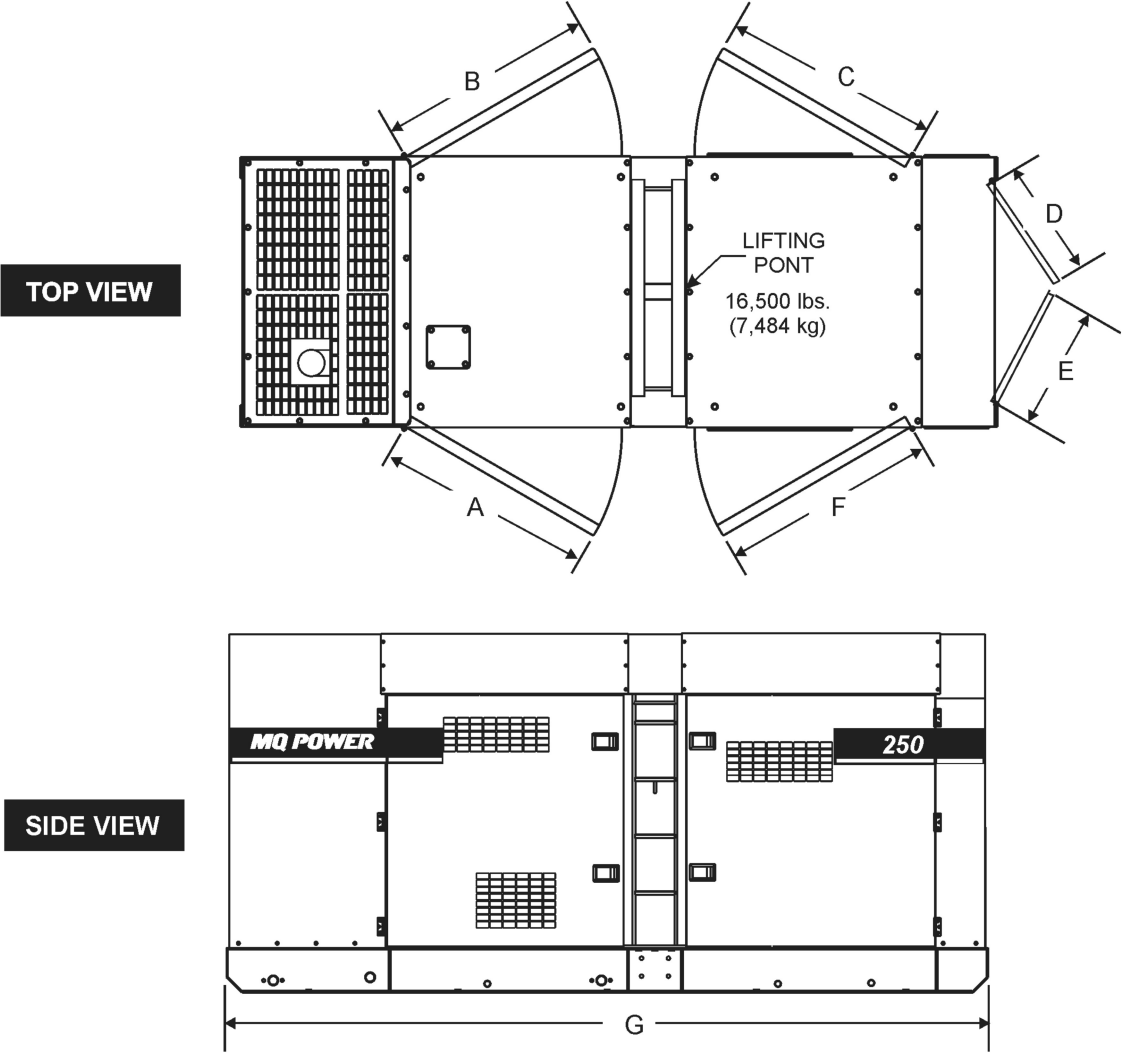

Figure 1. Dimensions

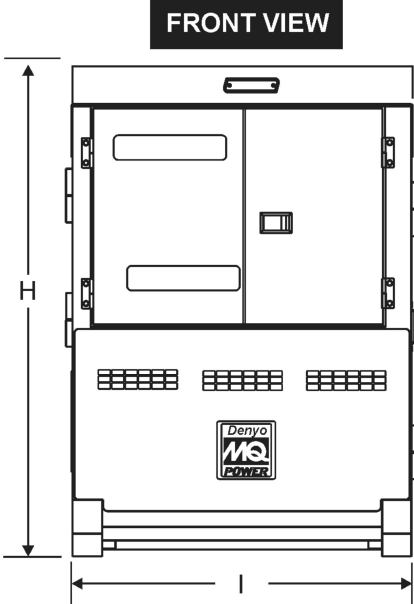

Table 3. Dimensions			
Reference Letter	Dimension in. (mm.)	Reference Letter	Dimension in. (mm.)
A	39.40 in. (1,010 mm.)	F	44.07 in. (1,130 mm.)
B	39.40 in. (1,010 mm.)	G	147.6 in. (3,750 mm.)
C	44.07 in. (1,130 mm.)	H	70.80 in. (1,800 mm.)
D	22.8 in. (585 mm.)	I	55.11 in. (1,400 mm.)
E	25.19 in. (640 mm.)		