

Specifications & Application Data

POWERFORCE® Natural Gas Series Generator Sets for Oil & Gas Industry Applications:

- POWERFORCE® Oil & Gas industry generators are designed to meet the rugged demands of the Oil & Gas industry environment, from to production.
- Each model has been designed to provide reliable continuous power to typical Oil & Gas industry electrical loads. All models are extensively tested to ensure they meet the performance requirements of the industry
- POWERFORCE® generators are packaged in a purpose built generator assembly and test facility. Each set goes through a fully documented test procedure before leaving our plant.
- POWERFORCE® models utilize the PSI Natural Gas engines governed to run at 1800 rpm for long life and durability.
- All Oil & Gas industry generators are designed and packaged as Prime Power Rated sets. See rating below for prime power kW



Voltage	Phase	Starting kVA (30% voltage dip)	PF	Prime		Amps @ 480V
				kW	kVA	
277/480	3	TBA	0.8	565	706	848

Rating Data of oil & Gas Industry Generators: Prime – Prime Rating are applicable for supplying continuous power with a 105°C alternator temperature rise.

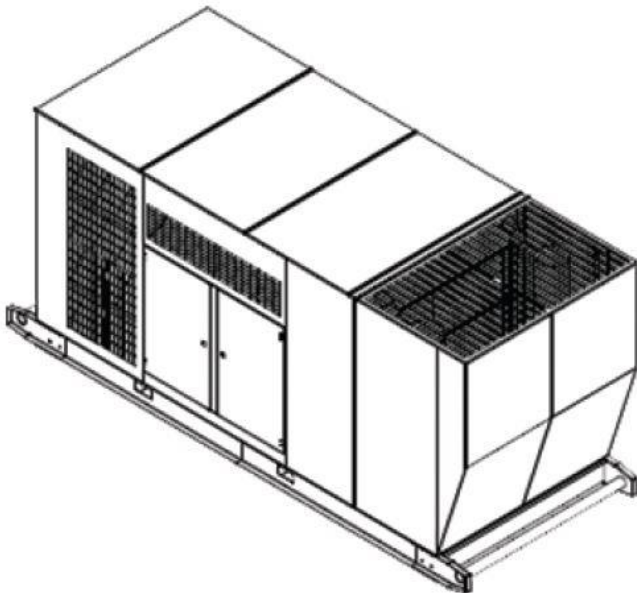

Engine Specifications	
Manufacturer	PSI
Engine model (Displacement liters)	PSI 31.8L
Type	NG 4-cycle
Number of cylinders & arrangement	12 V-type
Aspiration	Turbocharged
Nominal horse power	869hp
Speed	1800 rpm
Manufacturer model	Marathon model 572RSL6431
Type	Brushless 4-pole
Voltages (3 phases)	277/480V
Frequency	60Hz
Power factor	0.80
Insulation	Class H
Winding temperature rise (Prime)	105°C

Generator Digital Control Panel – For Manual, Automatic and Remote Control



DGC-2020 Digital Genset Controller:

The **POWERFORCE®** is equipped with a proven generator digital controller for rugged environments such as C&I applications, drill platforms, pump jack sites, and landfills. The premium control box has the capability to control the generator set manually, remotely or automatically.

Premium Specifications Include:

- NFPA-110 compliant
- User friendly, fully-configurable, programmable, microprocessor-based logic controller
- Offline Simulator BESTlogic™ helps identify and troubleshoot the logic
- High contrast display is easy to read

Model: PF-50G Natural Gas

Key Dimensions and Sound Levels

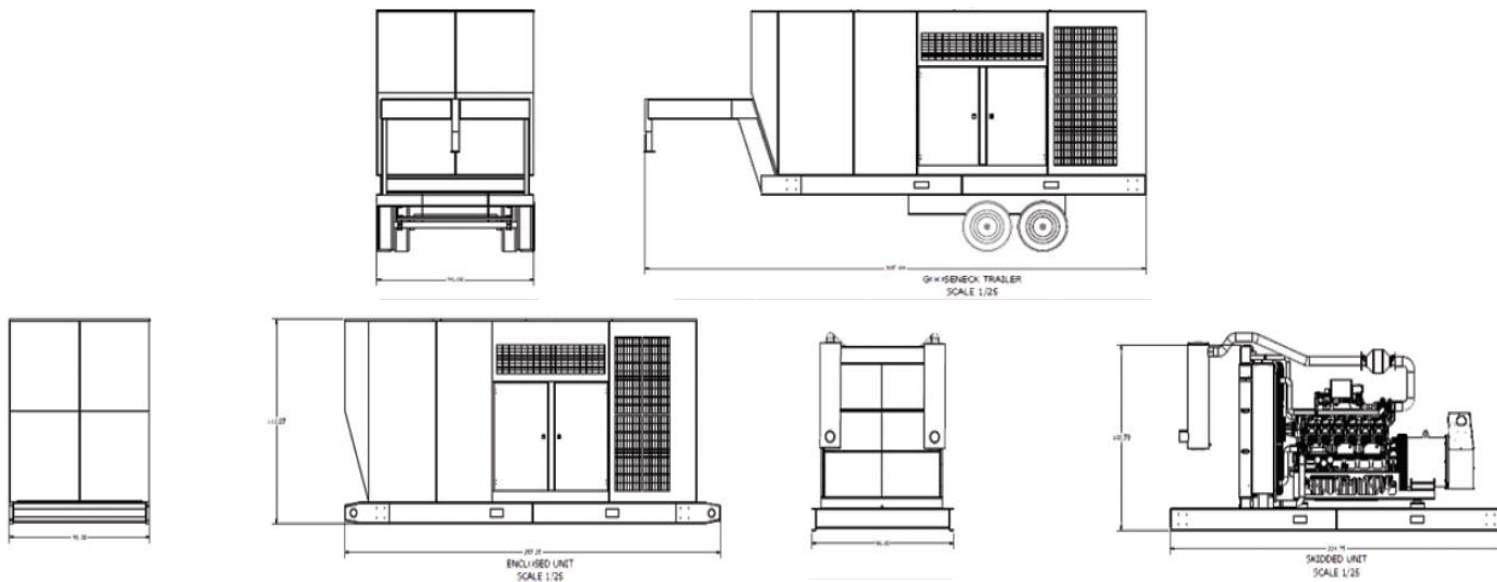

Fuel Data		Generator Set Enclosure Dimensions * (All dimensions are in inches and are approximated)				
Type	Consumption (cu. Ft./hour)	L = Length	Width	Height	Weight lbs	dBA
Natural Gas/LPG	6200 CFH	144.00"	96"	112"	20,500 dry	86

*All Measurements are approximate and for estimation purposes only. Weights are without fuel tank. Sound levels measured at 23ft (7m) and does not account for ambient site conditions.

POWERFORCE® Generator sets comply with applicable codes and standards



All data subject to change without notice. The information in this white-page specification is believed to be accurate but all recommendations are made without warranty, since the conditions of use are beyond Central Power Systems & Services control. Central Power Systems & Services disclaims any liability in connection with the use of this information, and does not warrant against infringement by reason of the use of any of its products in combination with other material or in any process. Central Power Systems & Services warrants only that the product complies with specifications agreed to in contracts of sale. Central Power Systems & Services reserves the right to change any of the technical information and data detailed in this paper.

CENTRAL
POWER SYSTEMS & SERVICES



POWERFORCE® - The right generator for the job
© 2014 POWERFORCE® a registered brand of Central Power Systems & Services. All rights reserved. Specifications are subject to change without notice

www.POWERFORCE.com

POWERFORCE® Corporate Office • 4501 W. Irving • Wichita • KS 67209 • Ph 316.943.1231